

# SPECIFICATION

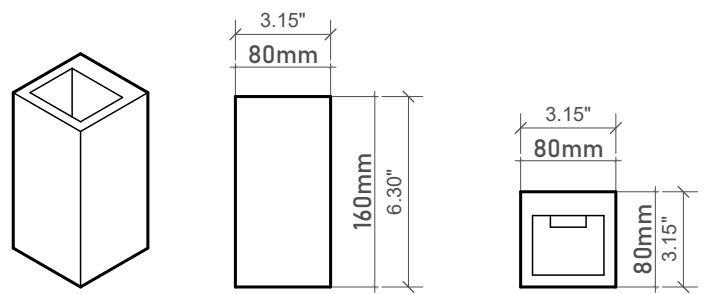

DWG

PRODUCT NO

# ML22

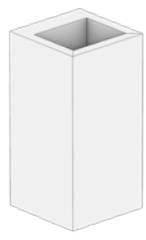

## Up Down Cube Wall Sconce

Type:	Wall Sconce
Globe type:	LED component
Voltage:	110V-220V compatible
Wattage:	3-6W
Environment:	Indoor
Installation:	Hard Wired Wall Sconce

**The Design**  
 A soaring reinterpretation of our cube sconce, this vertical luminaire (8x8x16cm) stretches the drama of Calacatta Viola and warmth of Travertine into a slender tower. Precision-cut and hand-assembled, it directs light both upward and downward to soft layer of light – perfect for framing doorways, highlighting art, or adding rhythm to minimalist stairwells, adding layers of light.

**Installation:**  
 Hardwired; professional mounting advised for secure placement.

**Features**  
**Handcrafted Uniqueness:** Each marble is hand-selected for its veining – no two sconces are alike.

**Sealed Stone:** Treated with a non-toxic sealant to protect against dust and moisture.

**Care Instructions**  
**Marble Base:** Wipe gently with a dry microfiber cloth; avoid water or chemicals.

**Note**  
 Due to the stone's weight, ensure walls are reinforced (e.g., studs, concrete).

# INSTALLATION

STEP 1



- Locate & Mark**
- Hold the hanging base against the wall at the desired height.
  - Use a level to ensure it's straight, then mark screw hole positions.
  - Verify no electrical wires/pipes are behind marked spots
- Drill & Secure**
- Drill holes at marked points using a masonry bit (for concrete/brick) or wood bit (for studs).
  - Insert wall plugs (expansion anchors) if needed.
  - Align the hanging base with holes and fasten using screws. Ensure it's firmly attached

STEP 2

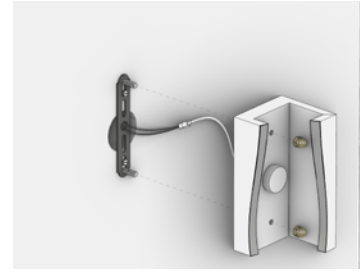

- Connect Wires**
- Important: Confirm power is OFF
  - Feed home wiring through the base's center opening.
  - Secure with wire nuts or terminal blocks. Wrap connections with electrical tape.
  - Tuck wires neatly into the base cavity.

STEP 3

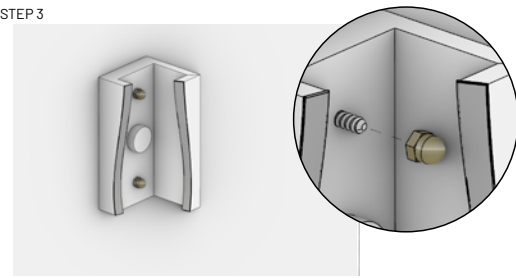

- Attach the Light**
- Align the lamp body with the hanging base.
  - Secure using provided screws or locking mechanism

STEP 4

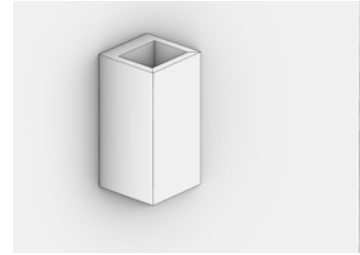

- Restore Power & Inspect**
- Turn power back on at the breaker.
  - Test the light. Check for flickering, unusual sounds, or heat.
  - If issues occur, immediately turn off power, recheck connections.